

COLEÇÃO

DESAFIOS DAS ENGENHARIAS:

ENGENHARIA DE COMPUTAÇÃO 3

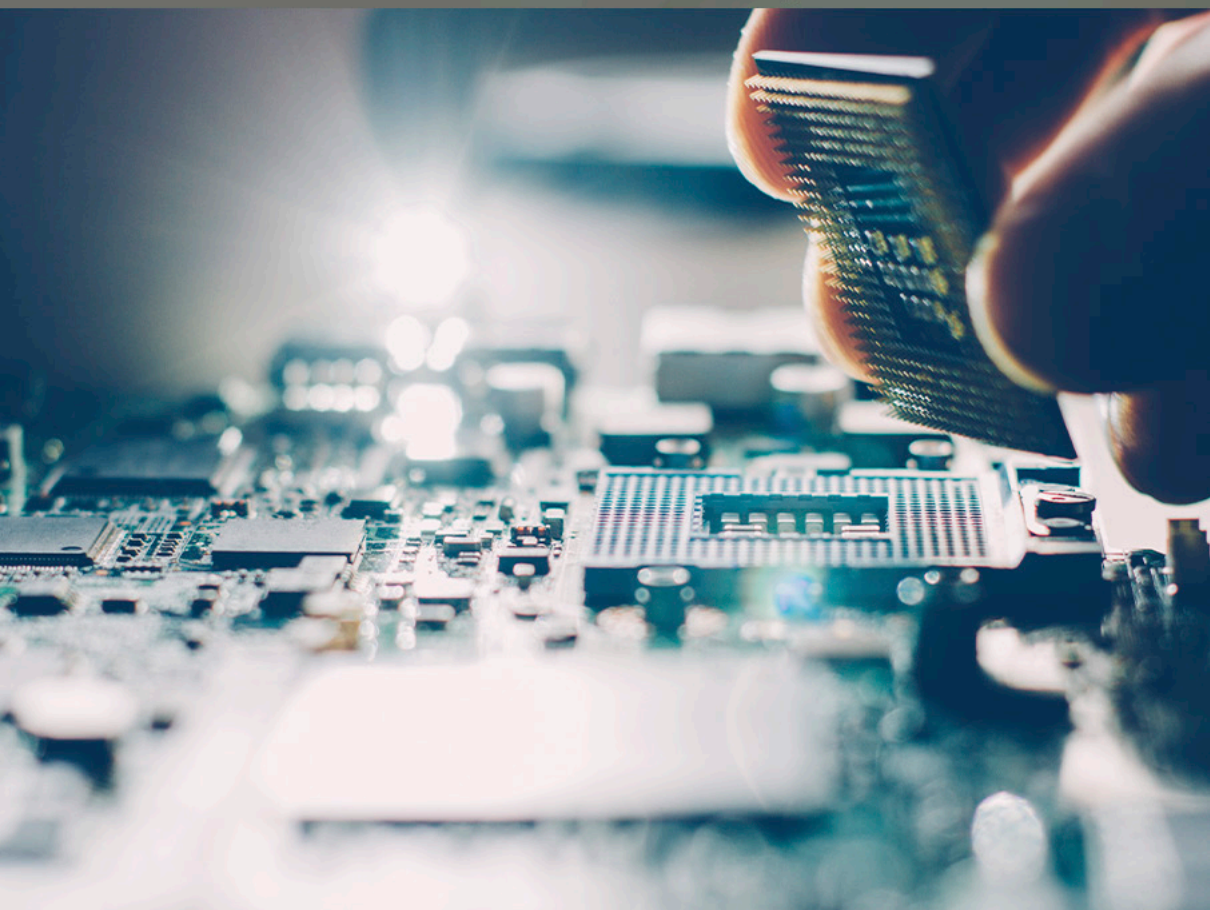

LILIAN COELHO DE FREITAS
(ORGANIZADORA)

Atena
Editora
Ano 2021

COLEÇÃO
DESAFIOS
DAS
ENGENHARIAS:

ENGENHARIA DE COMPUTAÇÃO 3

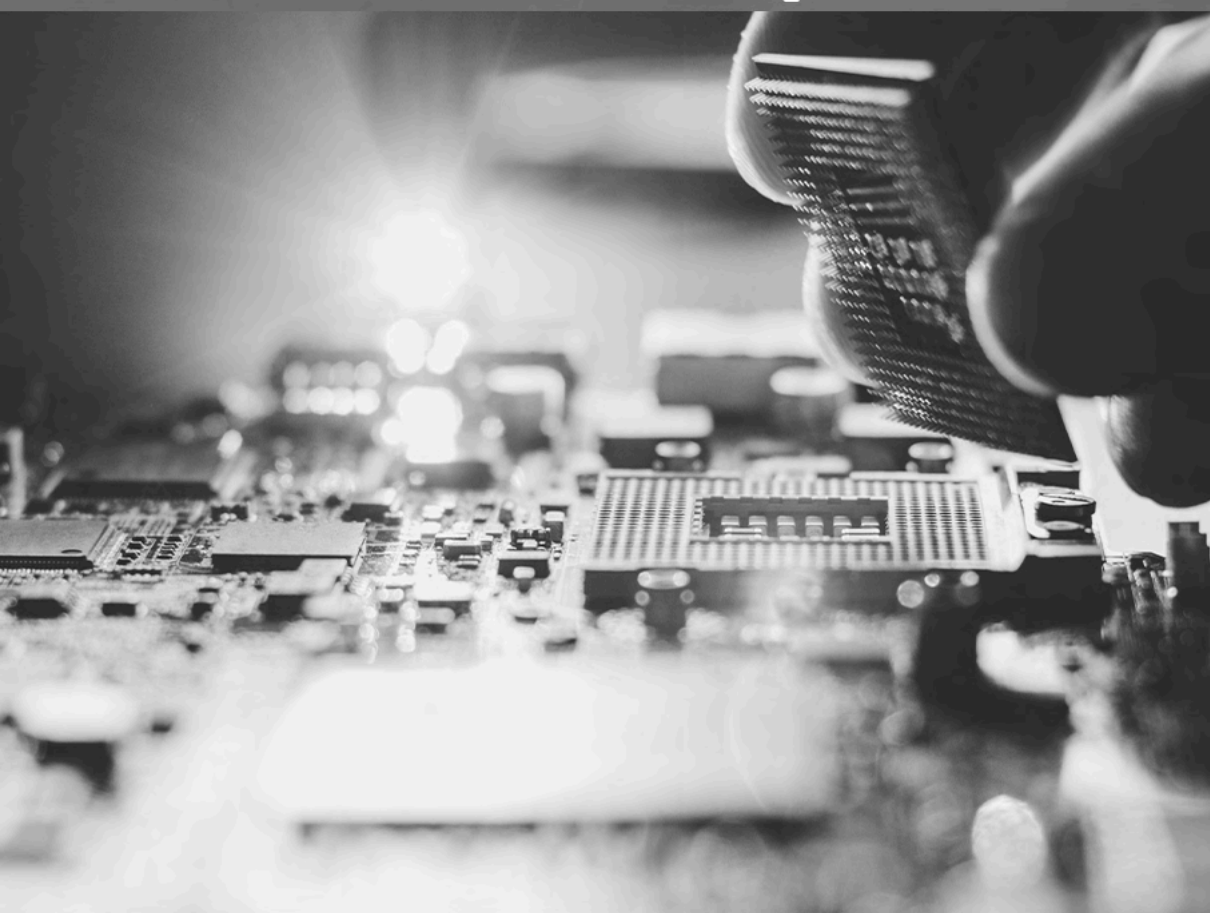

LILIAN COELHO DE FREITAS
(ORGANIZADORA)

Atena
Editora
Ano 2021

Editora chefe

Profª Drª Antonella Carvalho de Oliveira

Editora executiva

Natalia Oliveira

Assistente editorial

Flávia Roberta Barão

Bibliotecária

Janaina Ramos

Projeto gráfico

Camila Alves de Cremo

Daphynny Pamplona

Gabriel Motomu Teshima

Luiza Alves Batista

Natália Sandrini de Azevedo

Imagens da capa

iStock

Edição de arte

Luiza Alves Batista

2021 by Atena Editora

Copyright © Atena Editora

Copyright do texto © 2021 Os autores

Copyright da edição © 2021 Atena Editora

Direitos para esta edição cedidos à Atena Editora pelos autores.

Open access publication by Atena Editora



Todo o conteúdo deste livro está licenciado sob uma Licença de Atribuição *Creative Commons*. Atribuição-Não-Comercial-NãoDerivativos 4.0 Internacional (CC BY-NC-ND 4.0).

O conteúdo dos artigos e seus dados em sua forma, correção e confiabilidade são de responsabilidade exclusiva dos autores, inclusive não representam necessariamente a posição oficial da Atena Editora. Permitido o *download* da obra e o compartilhamento desde que sejam atribuídos créditos aos autores, mas sem a possibilidade de alterá-la de nenhuma forma ou utilizá-la para fins comerciais.

Todos os manuscritos foram previamente submetidos à avaliação cega pelos pares, membros do Conselho Editorial desta Editora, tendo sido aprovados para a publicação com base em critérios de neutralidade e imparcialidade acadêmica.

A Atena Editora é comprometida em garantir a integridade editorial em todas as etapas do processo de publicação, evitando plágio, dados ou resultados fraudulentos e impedindo que interesses financeiros comprometam os padrões éticos da publicação. Situações suspeitas de má conduta científica serão investigadas sob o mais alto padrão de rigor acadêmico e ético.

Conselho Editorial

Ciências Exatas e da Terra e Engenharias

Prof. Dr. Adélio Alcino Sampaio Castro Machado – Universidade do Porto

Profª Drª Ana Grasielle Dionísio Corrêa – Universidade Presbiteriana Mackenzie

Prof. Dr. Carlos Eduardo Sanches de Andrade – Universidade Federal de Goiás

Profª Drª Carmen Lúcia Voigt – Universidade Norte do Paraná

Prof. Dr. Cleiseano Emanuel da Silva Paniagua – Instituto Federal de Educação, Ciência e Tecnologia de Goiás

Prof. Dr. Douglas Gonçalves da Silva – Universidade Estadual do Sudoeste da Bahia
Prof. Dr. Eloi Rufato Junior – Universidade Tecnológica Federal do Paraná
Profª Drª Érica de Melo Azevedo – Instituto Federal do Rio de Janeiro
Prof. Dr. Fabrício Menezes Ramos – Instituto Federal do Pará
Profª Dra. Jéssica Verger Nardeli – Universidade Estadual Paulista Júlio de Mesquita Filho
Prof. Dr. Juliano Carlo Rufino de Freitas – Universidade Federal de Campina Grande
Profª Drª Luciana do Nascimento Mendes – Instituto Federal de Educação, Ciência e Tecnologia do Rio Grande do Norte
Prof. Dr. Marcelo Marques – Universidade Estadual de Maringá
Prof. Dr. Marco Aurélio Kistemann Junior – Universidade Federal de Juiz de Fora
Profª Drª Neiva Maria de Almeida – Universidade Federal da Paraíba
Profª Drª Natiéli Piovesan – Instituto Federal do Rio Grande do Norte
Profª Drª Priscila Tessmer Scaglioni – Universidade Federal de Pelotas
Prof. Dr. Sidney Gonçalo de Lima – Universidade Federal do Piauí
Prof. Dr. Takeshy Tachizawa – Faculdade de Campo Limpo Paulista

Diagramação: Daphynny Pamplona
Correção: Gabriel Motomu Teshima
Indexação: Amanda Kelly da Costa Veiga
Revisão: Os autores
Organizadora: Lilian Coelho de Freitas

Dados Internacionais de Catalogação na Publicação (CIP)

C691 Coleção desafios das engenharias: engenharia de computação 3 / Organizadora Lilian Coelho de Freitas. – Ponta Grossa - PR: Atena, 2021.

Formato: PDF

Requisitos de sistema: Adobe Acrobat Reader

Modo de acesso: World Wide Web

Inclui bibliografia

ISBN 978-65-5983-619-2

DOI: <https://doi.org/10.22533/at.ed.192212911>

1. Engenharia de computação. I. Freitas, Lilian Coelho de (Organizadora). II. Título.

CDD 621.39

Elaborado por Bibliotecária Janaina Ramos – CRB-8/9166

Atena Editora

Ponta Grossa – Paraná – Brasil

Telefone: +55 (42) 3323-5493

www.atenaeditora.com.br

contato@atenaeditora.com.br

DECLARAÇÃO DOS AUTORES

Os autores desta obra: 1. Atestam não possuir qualquer interesse comercial que constitua um conflito de interesses em relação ao artigo científico publicado; 2. Declaram que participaram ativamente da construção dos respectivos manuscritos, preferencialmente na: a) Concepção do estudo, e/ou aquisição de dados, e/ou análise e interpretação de dados; b) Elaboração do artigo ou revisão com vistas a tornar o material intelectualmente relevante; c) Aprovação final do manuscrito para submissão.; 3. Certificam que os artigos científicos publicados estão completamente isentos de dados e/ou resultados fraudulentos; 4. Confirmam a citação e a referência correta de todos os dados e de interpretações de dados de outras pesquisas; 5. Reconhecem terem informado todas as fontes de financiamento recebidas para a consecução da pesquisa; 6. Autorizam a edição da obra, que incluem os registros de ficha catalográfica, ISBN, DOI e demais indexadores, projeto visual e criação de capa, diagramação de miolo, assim como lançamento e divulgação da mesma conforme critérios da Atena Editora.

DECLARAÇÃO DA EDITORA

A Atena Editora declara, para os devidos fins de direito, que: 1. A presente publicação constitui apenas transferência temporária dos direitos autorais, direito sobre a publicação, inclusive não constitui responsabilidade solidária na criação dos manuscritos publicados, nos termos previstos na Lei sobre direitos autorais (Lei 9610/98), no art. 184 do Código Penal e no art. 927 do Código Civil; 2. Autoriza e incentiva os autores a assinarem contratos com repositórios institucionais, com fins exclusivos de divulgação da obra, desde que com o devido reconhecimento de autoria e edição e sem qualquer finalidade comercial; 3. Todos os e-book são *open access, desta forma* não os comercializa em seu site, sites parceiros, plataformas de *e-commerce*, ou qualquer outro meio virtual ou físico, portanto, está isenta de repasses de direitos autorais aos autores; 4. Todos os membros do conselho editorial são doutores e vinculados a instituições de ensino superior públicas, conforme recomendação da CAPES para obtenção do Qualis livro; 5. Não cede, comercializa ou autoriza a utilização dos nomes e e-mails dos autores, bem como nenhum outro dado dos mesmos, para qualquer finalidade que não o escopo da divulgação desta obra.

APRESENTAÇÃO

A Atena Editora tem a honra de presentear o público em geral com a série de *e-books* intitulada “*Coleção desafios das engenharias: Engenharia de computação*”. Em seu terceiro volume, esta obra tem o objetivo de divulgar aplicações tecnológicas da Engenharia de Computação na resolução de problemas atuais, com o intuito de facilitar a difusão do conhecimento científico produzido em várias instituições de ensino e pesquisa do país.

Organizado em 20 capítulos, este volume apresenta temas como utilização de aprendizagem de máquina na avaliação de riscos de infecção por COVID-19; dispositivos automatizados para administração de remédios; comunicação científica apoiada por realidade aumentada; métodos de elementos finitos aplicados na análise de materiais para indústria aeronáutica; aplicações de processamento digital de imagens e de algoritmos genéticos; entre diversas outras aplicações da automação e do desenvolvimento de *software*, combinados para melhorar as atividades do nosso dia-a-dia.

Dessa forma, esta obra contribuirá para aprimoramento do conhecimento de seus leitores e servirá de base referencial para futuras investigações.

Os organizadores da Atena Editora, agradecem especialmente os autores dos diversos capítulos apresentados, parabenizam a dedicação e esforço de cada um, os quais viabilizaram a construção deste trabalho.

Boa leitura.

Lilian Coelho de Freitas

SUMÁRIO

CAPÍTULO 1..... 1

EVALUATING THE RISK OF COVID-19 INFECTION BASED ON MACHINE LEARNING OF SYMPTOMS AND CONDITIONS VERSUS LABORATORY METHODS

Daniel Mário de Lima
João Henrique Gonçalves de Sá
Ramon Alfredo Moreno
Marina de Fátima de Sá Rebelo
José Eduardo Krieger
Marco Antonio Gutierrez

 <https://doi.org/10.22533/at.ed.1922129111>

CAPÍTULO 2..... 16

DISPOSITIVO AUTOMATIZADO PARA ADMINISTRAÇÃO DE REMÉDIOS

João Roberto Silva Teixeira
Alessandro Mainardi de Oliveira
Ricardo Neves de Carvalho

 <https://doi.org/10.22533/at.ed.1922129112>

CAPÍTULO 3..... 22

INTEGRAÇÃO ENTRE DADOS TEXTUAIS DE PRONTUÁRIOS ELETRÔNICOS DO PACIENTE (PEPS) E TERMINOLOGIAS CLÍNICAS

Amanda Damasceno de Souza
Eduardo Ribeiro Felipe
Fernanda Farinelli
Jeanne Louize Emygdio
Lívia Marangon Duffles Teixeira
Maurício Barcellos Almeida

 <https://doi.org/10.22533/at.ed.1922129113>

CAPÍTULO 4..... 35

COMPARATIVE ANALYSIS OF THE PERFORMANCE OF A ENRICHED MIXED FINITE ELEMENT METHOD WITH STATIC CONDENSATION FOR POISSON PROBLEMS

Ricardo Javier Hanco Ancori
Jose Diego Ayñayanque Pastor
Rómulo Walter Condori Bustincio
Eliseo Daniel Velasquez Condori
Roger Edwar Mestas Chávez
Fermín Flavio Mamani Condori
Jorge Lizardo Díaz Calle

 <https://doi.org/10.22533/at.ed.1922129114>

CAPÍTULO 5..... 45

COMPORTAMENTO DE PAREDE DE ALVENARIA ESTRUTURAL EM SITUAÇÃO DE INCÊNDIO: ANÁLISE NUMÉRICA

Jean Marie Désir

Luana Zanin

 <https://doi.org/10.22533/at.ed.1922129115>

CAPÍTULO 6..... 58

COMUNICAÇÃO CIENTÍFICA APOIADA POR REALIDADE AUMENTADA: O CASO DO APLICATIVO AUMENTANDO KIRIMURÊ

Vinícius Pires de Oliveira
Fernanda Vitória Nascimento Lisboa
Jéssica Duarte Souza
Brisa Santana Brasileiro
Hilma Maria Passos de Oliveira
Ingrid Winkler
Andrea de Matos Machado
Karla Schuch Brunet

 <https://doi.org/10.22533/at.ed.1922129116>

CAPÍTULO 7..... 64

CONTEXTUALIZAÇÃO DO CPS DE UMA CÉLULA ROBÓTICA, ATRAVÉS DO GÊMEO DIGITAL UTILIZANDO PROTOCOLO DE COMUNICAÇÃO OPC UA

Rogério Adas Pereira Vitalli

 <https://doi.org/10.22533/at.ed.1922129117>

CAPÍTULO 8..... 75

DESENVOLVIMENTO DE UMA ARQUITETURA DE SOFTWARE BASEADA EM CENÁRIOS ARQUITETURAIS, MEMORANDOS TÉCNICOS E VISÕES DO MODELO 4+1

Everson Willian Pereira Bacelli
Bruno Ferreira Cardoso
Wilson Vendramel

 <https://doi.org/10.22533/at.ed.1922129118>

CAPÍTULO 9..... 90

DEVELOPMENT OF AN AIDING TOOL FOR THE OPTIMAL DETAIL OF ACTIVE REINFORCEMENT USING GENETIC ALGORITHM

Victória Carino Neves
Guilherme Coelho Gomes Barros







 <https://doi.org/10.22533/at.ed.1922129119>





CAPÍTULO 10..... 106

ANÁLISE DOS EFEITOS DA MÉTRICA DE DISTÂNCIA NA EXTRAÇÃO DE CONJUNTOS DE SIMILARIDADE

André Eduardo Alessi
Bruno Duarte
Ives Renê Venturini Pola
Dalcimar Casanova
Marco Antonio de Castro Barbosa

 <https://doi.org/10.22533/at.ed.19221291110>

CAPÍTULO 11	119
ESTUDO SOBRE AUTOMATIZAÇÃO DE EQUIVALÊNCIA DE FUNÇÕES	
Lucas Fernando Frighetto	
Fábio Hernandez	
 https://doi.org/10.22533/at.ed.19221291111	
CAPÍTULO 12	142
ESTUDO SOBRE O CONTROLE REMOTO DE DISPOSITIVOS MICROCONTROLADOS UTILIZANDO DISPOSITIVOS MÓVEIS	
João Vítor Fernandes Dias	
Fermín Alfredo Tang Montané	
 https://doi.org/10.22533/at.ed.19221291112	
CAPÍTULO 13	163
HERRAMIENTAS TECNOLÓGICAS APLICADAS EN EL DIBUJO ASISTIDO POR COMPUTADORA EN LA MODALIDAD A DISTANCIA	
Liliana Eneida Sánchez Platas	
Celia Bertha Reyes Espinoza	
Olivia Allende Hernández	
 https://doi.org/10.22533/at.ed.19221291113	
CAPÍTULO 14	174
HISTÓRICO DAS MULHERES NA TECNOLOGIA DA INFORMAÇÃO E ANÁLISE DA PARTICIPAÇÃO FEMININA NOS CURSOS SUPERIORES DO BRASIL	
Vívian Ludimila Aguiar Santos	
Thales Francisco Mota Carvalho	
Maria do Socorro Vieira Barreto	
 https://doi.org/10.22533/at.ed.19221291114	
CAPÍTULO 15	186
IDENTIFICAÇÃO DO MODELO DINÂMICO DE UMA TURBINA EÓLICA: ESTUDO DE CASO DA NORDTANK NTK 330F	
Gustavo Almeida Silveira de Souza	
Edgar Campus Furtado	
Leandro José Evilásio Campos	
Cristiane Medina Finzi Quintão	
 https://doi.org/10.22533/at.ed.19221291115	
CAPÍTULO 16	199
COMFORT IN VIBRATIONS FOR THE STEEL-CONCRETE COMPOSITE FLOORS: AN APPRAISAL FOR REVIEW OF ABNT NBR 8800:2008	
João Vítor V. Freire	
André V. Soares Gomes	
Adenícia Fernanda G. Calenzani	
Johann A. Ferrareto	
 https://doi.org/10.22533/at.ed.19221291116	

CAPÍTULO 17	224
FINITE ELEMENT METHOD APPLIED TO MECHANICAL ANALYSIS OF AERONAUTICAL RIBS IN CARBON FIBER AND 7075 ALUMINUM ALLOY	
Alex Fernandes de Souza	
 https://doi.org/10.22533/at.ed.19221291117	
CAPÍTULO 18	236
MÉTODO PARA CALCULAR A ÁREA DE SUPERFICIAL DE RAÍZES POR PROCESSAMENTO DIGITAL DE IMAGENS	
Marcio Hosoya Name	
 https://doi.org/10.22533/at.ed.19221291118	
CAPÍTULO 19	244
LOCAL MESHFREE METHOD OPTIMIZATION WITH GENETICALGORITHMS	
Wilber Vélez	
Flávio Mendonça	
Artur Portela	
 https://doi.org/10.22533/at.ed.19221291119	
CAPÍTULO 20	258
NAVEGACIÓN VIRTUAL 2D Y 3D EN UN ENTORNO WEB	
Víctor Tomás Tomás Mariano	
Felipe de Jesús Núñez Cárdenas	
Jorge Hernández Camacho	
Isaura Argüelles Azuara	
Guillermo Canales Bautista	
 https://doi.org/10.22533/at.ed.19221291120	
SOBRE A ORGANIZADORA	268
ÍNDICE REMISSIVO	269

DEVELOPMENT OF AN AIDING TOOL FOR THE OPTIMAL DETAIL OF ACTIVE REINFORCEMENT USING GENETIC ALGORITHM

Data de aceite: 01/11/2021

Victória Carino Neves

Departamento de Engenharia Civil do Centro
Universitário Ibmec
Rio de Janeiro/RJ, Brazil

Guilherme Coelho Gomes Barros

Departamento de Engenharia Civil do Centro
Universitário Ibmec
Rio de Janeiro/RJ, Brazil

ABSTRACT: The aim of this paper is to present the development of an auxiliary tool for the optimal detail of active reinforcement on a prestressed concrete section. To achieve it, the methodology considers normative requisites and the tension required at the most critical section of the beam. The problem of optimization seeks to minimize the volume of steel while satisfying the conditions of minimum cover and spacing between reinforcement cables. Design variables are the number of strands per cable and the position of each cable within cross section. Due to the nature of the variables and the constraints involved, genetic algorithm seems to be the most suitable optimization procedure. Hence, the proposed methodology is implemented using the native implementation of genetic algorithm of MATLAB, a broadly used computer program in academy. The developed tool allows to detail different sections, since it treats the cross section as a general polygon. Thereby, it allows exploitation of new sections for future projects, as well as assisting in the time of design. It is

worth mentioning that a complete automated prestressed concrete executive project is still far down the road. Numerical examples are analyzed to demonstrate the efficiency of the presented tool and to illustrate its usage in a actual life design process.

KEYWORDS: Prestressed Concrete, Optimal Detailing, Genetic Algorithm

1 | INTRODUCTION

Concrete is an ancient material that was already known by the time of the Roman Empire. It is formed by a mixture of cement, water and aggregated. It was used as a mass to lay bricks, among other functions. In the nineteenth century the material regained attention, once realized that it had some advantages over the materials used at that time. Among the advantages of concrete, it is worth mentioning that it is moldable and have workability when wet, it is resistant to loads and fire, and it increases the service life of the structure after cured.

Despite all these advantages this material is fragile and works better resisting compression than traction. To cope with that, steel is added to concrete in regions where tensile stresses are predominant. The result is a material of good strength and ductility, if properly designed. The steel might even be prestressed, allowing the compression strength of concrete to be more effective in bending. This constructive method consisting of the application of tension in steel

cables in traction regions of the structure before or after the curing of the concrete and without or with bonding is often referred to as prestressed concrete.

The advantages of this type of construction are: the execution of spans larger than the reinforced concrete; the reduction of deformations and crack opening; a shorter time in implementation of construction; saving concrete, since it uses steel and high-strength concrete; the reduction of the weight of the structure, since it can build with more slenderness; and other more. However, there are also disadvantages such as the high price of steel and the need for skilled labor. It can be used in a variety of ways, such as in large slabs and beams, foundations, anchored walls, dams, bridges, and recovery of compromised structures.

The prestressed concrete design is carried out through the concrete adopted, the active and passive reinforcement and type of execution – initial or posterior bonding or without bonding. In addition, it is necessary to take into account the class of environmental condition. Then the cross-section of the structure is defined, which furnishes the structural self-weight and its flexural rigidity. After that it is necessary to pre-dimension the active reinforcement.

In the process of designing prestressed concrete structures, the tension that must be provided to concrete is calculated first to match the specified limits of designing standards. Subsequently, it is needed to find an active reinforcement detail that provides the required tension and meets the coverage and spacing requirements of designing codes. However, this process is manual and laborious. In general, it starts with simplifying hypothesis, which, when missed, need to be changed leading to an iterative process.

This process is currently solved, only, from an initial estimate based on the experience of the designer. Thus, it is an unfavorable process to the new designers and make the exploitation of innovative sections difficult. In case of convergence, there is a detail that serves the required tension. However, this is only one possible outcome, and there is no guarantee that is the best. Thus, a detail methodology more automated and that seek out the less consumption of materials would reduce the time demanded for this step significantly and would provide generally more economic solutions and with reduction of rework.

In order to decide the method of optimization to be used to produce this tool, some methods were checked such as the gradient-based method, meta-heuristics, natural computing and genetic algorithm, which was chosen because in addition to the ability to solve problems of optimization with discrete variables, they work with discontinuous functions and not differentiable.

This article will introduce the development of an automated tool to support the detailing step of the active reinforcement with full or limited prestressing, with posterior adhesion using the genetic algorithm. Specifically, for a given section and its prestressing tension requirements known, seeking the most economical detailing in relation to the volume of steel, avoiding the manual process and rework.

2 | PRESTRESSED CONCRETE

Prestressed concrete structures must agree the requirements of ultimate limit state (ULS) and serviceability limit state (SLS). However, the information required to verify those limit states is only available after the structure is completely detailed. Therefore, is a common practice to estimate some of the values involved to encounter the missing ones. In prestressed concrete design, commonly, the predimensioning of active reinforcement begins by calculating the total prestress required to meet the SLS's at infinity time (when long-term losing process have already been completed). The SLS equation may, in general, be written as

$$\sigma_F + \sigma_{P_\infty}^c \leq \sigma_c, \quad (1)$$

in which, σ_F is the stress due to the specified load combination, $\sigma_{P_\infty}^c$ is the stress caused in concrete by prestressing at infinity time and σ_c is the limit stress related to each SLS.

From Eq. (1) it is possible to determine the maximum prestressed required, hereinafter (x_p, y_t) is referred to as the point within a beam in which the prestressed required is maximum. This prestress may also be written, according to classic solid mechanics, as

$$\sigma_{P_\infty}^c = \frac{P_\infty^c}{A} - \frac{M_{P_\infty}^c y_t}{I} \quad (2)$$

in which, P_∞^c is the prestress force at concrete at infinity time, A is the cross-section area, $M_{P_\infty}^c$ is the bending moment caused by prestress eccentricity and I is the cross-section moment of inertia. Is important pointing out that Eq. (2) is also an approximation since it does not represent the actual prestress in statically determined structures.

The prestress force P_∞^c may be calculated as

$$P_\infty^c = -P_\infty = -nN p_\infty = -nN \eta_\infty p_i \quad (3)$$

in which, P_∞ is the prestress force at steel at infinity time, n is the number of cables, N is the number of strands per cable, p_∞ is the force at infinity time per strand, which is obtained estimating the longterm prestress losses through coefficient η_∞ and through the initial prestress force per strand p_i [1]. The bending moment due to prestress force is given by

$$M_{P_\infty}^c = -\sum_{k=1}^n P_{\infty,k}^c y_k, \quad (4)$$

in which $P_{\infty,k}^c$ is the prestress force at concrete at infinity time of k -th cable and y_k is its position. Since all cables have the same number of strands, the force in each of them is considered equal, therefore, Eq. (4) becomes

$$M_{P_\infty}^c = -P_\infty^c e, \quad (5)$$

in which, e is the eccentricity of an equivalent cable. This eccentricity e is given by

$$e = \frac{\sum_{k=1}^n y_k}{n} \quad (6)$$

2.1 Representation of the cross-section

In order to make the algorithm able to handle prestressed concrete cross-section of any shape and in the presence, or not, of inner holes, the external boundary and each hole are represented by polygons. The information of each polygon are storied as matrices of shape $(m_k, 2)$, m_k being the number of vertices. Each row represents a vertex, storing in the columns its x and y coordinates. The vertices must be ordered counterclockwise for the boundary, and clockwise for the holes. For example, a box crosssection with 20cm width, 40cm height and 5cm thickness, shown in Fig. 1 with an adopted coordinate system, would have its external boundary represented as in Table 1 and its hole storied as in Table 2.

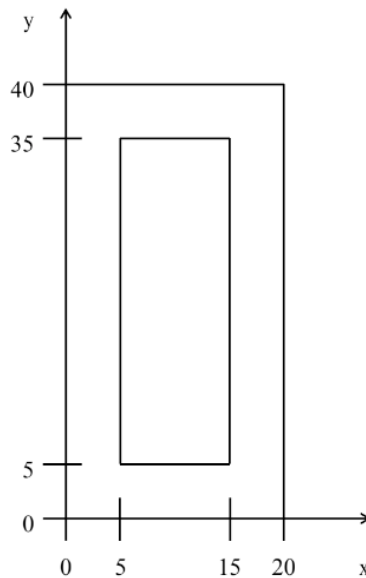

Figure 1. Box cross-section within coordinate system.

0	0
20	0
20	40
0	40

Table 1. Matrix representing boundary's polygon.

5	5
15	5
15	35
5	35

Table 2. Matrix representing hole's polygon.

2.2 Calculation of cross-section properties

The general formula for the area A and first and second moment of inertia Q and I may be found using Green's theorem for performing a bound integral instead of a domain integral.

Therefore, one may find

$$A = \frac{1}{2} \sum_{i=1}^m (x_i y_{i+1} - x_{i+1} y_i), \quad (7)$$

$$Q_x = \frac{1}{6} \sum_{i=1}^m (x_i + x_{i+1})(x_i y_{i+1} - x_{i+1} y_i), \quad (8)$$

$$Q_y = \frac{1}{6} \sum_{i=1}^m (y_i + y_{i+1})(x_i y_{i+1} - x_{i+1} y_i), \quad (9)$$

$$I_{xx} = \frac{1}{12} \sum_{i=1}^m (y_i^2 + y_i y_{i+1} + y_{i+1}^2)(x_i y_{i+1} - x_{i+1} y_i), \quad (10)$$

$$I_{yy} = \frac{1}{12} \sum_{i=1}^m (x_i^2 + x_i x_{i+1} + x_{i+1}^2)(x_i y_{i+1} - x_{i+1} y_i), \quad (11)$$

$$I_{xy} = \frac{1}{24} \sum_{i=1}^m (x_i y_{i+1} + 2x_i y_i + 2x_{i+1} y_{i+1} + x_{i+1} y_i)(x_i y_{i+1} - x_{i+1} y_i) \quad (12)$$

2.3 Verification of coverage and spacing

Coverage is the smaller distance between the interface between concrete and steel and the free surface of concrete. That distance is often lower bounded by design standards so that concrete effectively protects the steel from corrosion and fire exposure. That limitation is taken into the algorithm as a constraint in the optimization process. Hence, the coverage must be evaluated in the cross-section polygon. Coverage constraint may be written as

$$d - \frac{\phi}{2} \geq \bar{c}, \quad (13)$$

in which, d is the signed distance between the cable's center and the boundary or hole, ϕ is the cable external diameter, and \bar{c} is the minimum cover by design code.

The sign in d must be positive if the point is inside the polygon and negative otherwise. The algorithm for computing d is divided in two part, one calculates its module and the other

its sign, so that

$$d = \text{sign}(d)kdk . \quad (14)$$

The distance kdk is calculated through Algorithm 1.

<p>Algorithm 1: Calculation of unsigned distance</p> <p>Input: point, boundary, holes Output: Smallest distance between point and the cross-section $\min dist$ $dist \leftarrow \text{distancePointPolygon}(\text{point}, \text{boundary});$ // Algorithm 2</p> <p>foreach hole do $dist \leftarrow \text{distancePointPolygon}(\text{point}, \text{hole});$ // Algorithm 2 if $dist \leq \min dist$ then $\min dist \leftarrow dist$ end</p> <p>end</p>
<p>Algorithm 2: distancePointPolygon</p> <p>Input: point, polygon Output: Smallest distance between point and polygon $i \leftarrow 1;$ $\text{segment} = \text{polygon}(i);$ $\min dist \leftarrow \text{distancePointSegment}(\text{point}, \text{segment});$</p> <p>while $i \leq \text{number of segments in polygon}$ do $i \leftarrow i+1;$ $\text{segment} = \text{polygon}(i);$ $dist \leftarrow \text{distancePointSegment}(\text{point}, \text{segment});$ if $dist \leq \min_dist$ then $\min_dist \leftarrow dist$ end</p> <p>end</p>

In Algorithm 2, function *distancePointSegment* is called, its implementation consists of returning the smallest distance between a point and a segment. This requires basic math and, hence, the algorithm is suppressed. The sign function in Eq. (14) is declared to determine whether a cable is inside or outside the cross-section polygon. This is accomplished using the ray casting algorithm, which according to Hughes et al. [2] “Ray casting is a direct process for answering an intersection query”. From the point of interest, an ray is traced in any direction counting the number of intersections it has with the polygon. If the number of intersections is even the point is outside polygon, thus negative sign is returned. On the other hand, if the number of intersections is odd, the point is inside, and positive sign is returned.

Spacing is the distance that must be left free between prestressing cables. In general, design codes prescribe bounds on the horizontal spacing a_h and the vertical displacements a_v [3]. That condition may be verified as follows. Given two cables, cable i centered at (x_i, y_i) with external diameter d_i and cable j centered at (x_j, y_j) with external diameter d_j compute

$$dx_{ij} = |x_j - x_i|, \quad (15)$$

$$dy_{ij} = |y_j - y_i|, \quad (16)$$

then, define

$$d_{ij} = \max(dx_{ij}, dy_{ij}), \quad (17)$$

form which the spacing condition is given by

$$d_{ij} - \frac{\phi_i}{2} - \frac{\phi_j}{2} \geq \begin{cases} a_h, & \text{if } d_{ij} = dx_{ij} \\ a_v, & \text{if } d_{ij} = dy_{ij} \end{cases} \quad (18)$$

3 | GENETIC ALGORITHM

The genetic algorithm (GA) was used in the development of this tool because it is a method suitable for finding the global optimal of the problem with multiple local optimum solutions. Additionally, GA is efficient in structural problems that can often be complex de Leon F. de Carvalho [4]. For its implementation MATLAB has been used, a computational software, broadly used in the academic community. Also, MATLAB's GA implementation, allows for easy user customization.

The optimization using this algorithm follows a predetermined set of steps, as illustrated in Fig. 2. The first part consists of the problem setup. The first step is the problem acknowledgement, in which all information about the problem is gathered. The second step is the solution coding, in this step the chromosome is defined. It consists of the coding representation of all possible solutions to the problem.

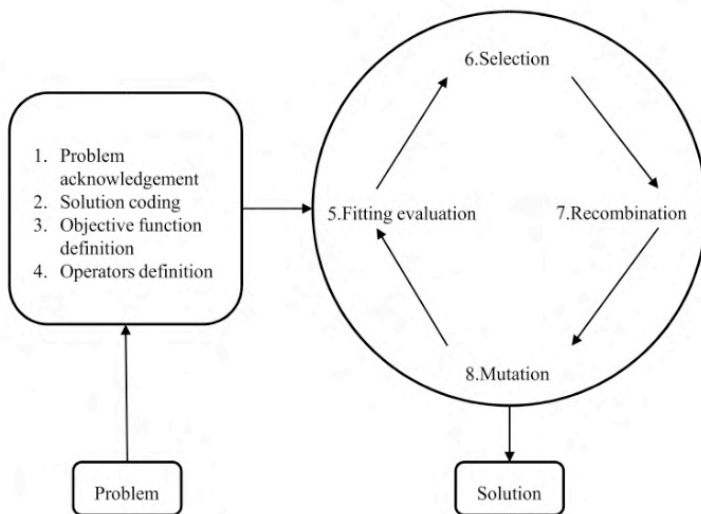

Figure 2. Box cross-section within coordinate system.

The third step is the definition of the objective function, which tells the algorithm the best between two solutions. The fourth step consists of the operators definition which drives

the formation of new populations, and the formation of the initial population.

The second part of the algorithm performs the optimization altering the current population and forming new ones in the seek of the global optima. Four main steps are worth mentioning: fitting evaluation, in which the objective function is evaluated for each individual; selection, which is the selection of individuals for reproduction, the most better fitted are the more likely to generate descendents; recombination, is the step where the chromosomes of the selected parents are mixed up together to form, in general, two new individuals; and mutation, which is the randomly change in the chromosome of a recent-generated individual. The algorithm proceeds within this cycle until it hits the end of pre-established number of generations. It is also common for the algorithm to stop before that, if it hits a stalling point, this is usually measured as the number of generations without finding a new best solution.

3.1 Representation of the Algorithm and Operators

In order to represent the algorithm the chromosome in the classical representation of GA is decoded as a vector of fixed size. Each position of this vector called a gene. The chromosome adopted in this work must represent any possible detailing of prestressed concrete section. First, it is necessary to define the maximum possible number of cables in the solution n , thus the chromosome may have fixed length. Then, to make it possible for the solution to have less cables than the maximum defined value, a flag indicating if each cable is to be considered in the detailing is added. A flag is a 1 or 0 variable, if its value is 1, the cable is on the detailing.

In Fig. 3, the genes, represented in each box, are: N the number of strands per cable; f_i the flag of i -th cable; and x_i and y_i are x and y coordinates of the i -th cable. Here, $i = 1, \dots, n$ and n is the total possible number of cables. For each gene there is a set of possible values, for instance the number of strands per cable are limited to manufacturer's specifications; the flag, as aforementioned, may be valued to 0 or 1; and x and y is restricted to lie inside the bounding box of the cross-section polygon.

In addition to the representation of the chromosome, some aspects of the GA may be addressed so that the algorithm performs well, prompting good results and reducing computational costs. The most discussed factors in genetic algorithms are population size, crossover rate, mutation rate and number of generation. Furthermore, for the sake of performance, operators may also have to be addressed. They drive the algorithm through the search space towards the solution. Among them it is worth mentioning initial population, crossover function and mutation function. A brief discussion of each is presented in the sequel.

The population size is the number of individuals, which means, in this case, different detailing that are evaluated at each generation. Since each individual is evaluated for the fitness function and constraints, the larger its value the longer the algorithm takes. On the other hand, a small population size may not grant enough coverage of search domain, commonly

leading to a local optimum. For all numerical experiments carried in the development of this work, a population size of 50 was found to be suitable.

The number of generations is a stopping criteria, since it determines the amount of cycles of evolution the genetic algorithm will take. This parameter cannot be neither too small, so that the algorithm will stop prematurely, nor too big, so that the algorithm wastes time going through sub-optimal solutions after having found the optimum. In the examples analyzed in developing this work it has been found that a value of 100 suffices.

The rates of crossover and mutation are complementary in MATLAB. While setting too high crossover rate may lead to local optimum, setting too high mutation rate makes the algorithm to perform randomly, not converging to any solution. The crossover rate of 50% was found adequate for the examples investigated in this work.

3.2 Initial Population

An initial population is an important feature for GA. They consist of a set of initial guesses for the solution. If warm guesses are given, the optimization converges faster and to better solutions. For the development of a supporting tool to the detailing three procedures are employed to determine the initial population. They are: randomly creation (MATLAB's default); via a continuous approximation of the original problem; and regarding the eccentricity, which is an incorporation of a practical rule.

For the initial population of continuous approximation, discrete variables, non-differentiable functions are approximated. GA is used to find solutions of global minimum of the continuous problem. To reach the minimum amount of steel the chromosome illustrated in Fig. 3 is used. In Fig. 3 A is the area of each cable, x_i and y_i are the coordinates of the i -th cable. Being $i = 1, \dots, n$ and n is the total possible number of cables. The problem is solved for different n , from one to a predefined maximum number of cables. Therefore, for each n it is sought the minimum area the n cables have to have and their position, so that the constraints are met.

A	x1	y1	...	xi	yi	...	xn	yn
---	----	----	-----	----	----	-----	----	----

Figure 3. Initial population estimation chromosome of the continuous problem.

The constraints depend on the cable's diameter, since coverage and spacing are related to it. This diameter is then approximated through a continuous function. Varying the number of strands in a cable it is possible to correlate cable's area and external diameter [5]. In Fig. 4, the data is shown in blue dots, while the approximation function is shown in solid red line.

In addition, a practical rule of structural concrete design is incorporated. It consists on assuming that the centroid of reinforcement area lies at 10 percent of the cross-section total

height from the most tensioned fiber. The initial solution based on this rule is found by calculating the number of strands needed to meet the stress constraint, Eq. (2), then calculating an well-balanced number of cables, and finally setting all cables at the aforementioned y -position with zero x coordinate. It is worth mentioning that although this solution is guaranteed to meet the stress constraint, spacing constraints are obviously not met and so are the cover constraints, potentially.

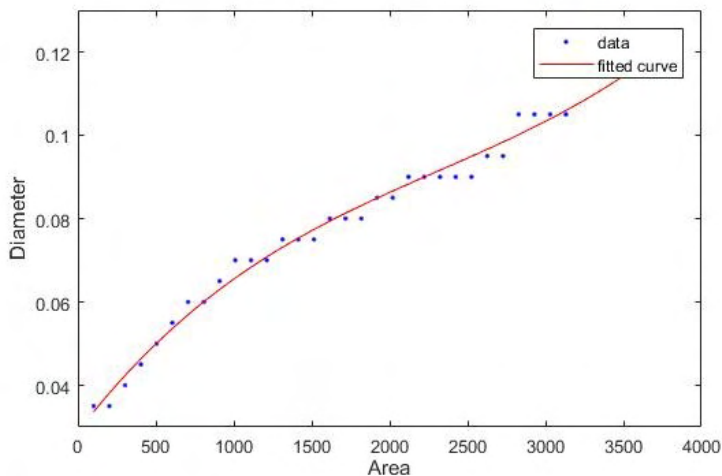

Figure 4. Fitting steel area and cable diameter data.

4 | OBJECTIVE FUNCTION

The objective function is the function of optimization that is to be minimized or maximized in a project. In this work the objective function must be directly related to the area of prestressing steel, then the total number of strands in detailing is a good choice of the objective function. That function may be written as

$$F = N \sum_{i=1}^n f_i \quad (19)$$

which is the number of strands per cable N multiplied by number of cables in the detailing, calculated by the sum of the active flags f_i .

Throughout the development of the work the function has been enhanced to take into account experience and get more practical solutions. In this way, a term is added to bring the cables close to the more tensioned fibers. Since, with the first function, the resulting cables did not have an ideal arrangement. So the function has been changed to

$$F = N \sum_{i=1}^n f_i + \sum_{i=1}^n f_i (y_i - y_t)^2 \quad (20)$$

in which, y_i is the coordinate of the most tensioned fiber. With additional tests, it could have been seen that this function can be even bettered for practical application. The improvement made regards symmetry of the detailing. Since symmetric detailing are of better execution, the function was changed to

$$F = N \sum_{i=1}^n f_i + \sum_{i=1}^n (f_i y_i - y_i)^2 + \sum_{i=1}^n (x_i)^2 f_i. \quad (21)$$

5 I RESULTS

In this section the carried out tests are presented. The examples concern prestressed beams with posterior adhesion. The Brazilian design codes NBR6118 [6], NBR8681 [7] are employed. They deal with the design of concrete structures, and actions and safety in structures, respectively. Additionally, the prestressing steel adopted was CP190RB12.7, which, according to manufacturer's, has area of one strand $A_{1p} = 101\text{mm}^2$. Moreover, it is used concrete of compressive strength $f_{ck} = 35\text{MPa}$, made of coarse granite aggregate with maximum diameter of 19mm and cement CPV-ARI.

According to Brazilian concrete standard, the cover c , considering CAAIII must respect

$$c \geq 45\text{mm}, \quad (22)$$

and also,

$$1.2c \geq d_{\max}, \quad (23)$$

$$c \geq \frac{\phi}{2}, \quad (24)$$

in which, d_{\max} is the maximum diameter of coarse aggregate.

Still according to NBR6118 [6], the horizontal spacing a_{fi} must respect

$$a_h \geq 20\text{mm}, \quad (25)$$

$$a_h \geq \emptyset, \quad (26)$$

$$a_h \geq 1.2d_{\max}, \quad (27)$$

while the vertical spacing a_v must respect

$$a_v \geq 20\text{mm}, \quad (28)$$

$$a_v \geq \emptyset, \quad (29)$$

$$a_v \geq 0.5 d_{\max}, \quad (30)$$

5.1 Girder section

Figure 5 illustrates the beam considered, whose base cross-section is illustrated in Fig. 6. The detailing was performed for most critical section of the beam. The solution found has two cables of diameter $\phi = 9\text{cm}$ with $N = 22$ strands per cable, as depicted in Fig. 7.

From Fig. 7, the coverage encountered is $c = 90\text{mm} - \varnothing/2 = 45\text{mm}$, which respects

$$c = 45\text{mm} \geq 45\text{mm},$$

$$1.2c = 54\text{mm} \geq d_{\max} = 19\text{mm},$$

and the horizontal spacing $a_{\bar{i}} = 183.3\text{mm} - \varnothing = 93.3\text{mm}$ respects design code limits

$$a_{\bar{i}} = 93.3\text{mm} \geq 20\text{mm},$$

$$a_{\bar{i}} = 93.3\text{mm} \geq \frac{\varnothing}{2} = 45\text{mm},$$

$$a_{\bar{i}} = 93.3\text{mm} \geq 1.2d_{\max} = 22.8\text{mm}.$$

It is yet notorious to say that the tension for this test was also met, since

$$\sigma P_{\infty}^c = -29253\text{kPa} \leq \sigma_c - \sigma_f = -27926\text{kPa},$$

For this it was used an initial population of 250, a set of 100 generations at a crossover rate of 50 percent. It is worth mentioning that the resulting using objective function Eq. (19) the result obtained is shown in Fig. 8, while the result depicted in Fig. 9 is found using objective function Eq. (20).

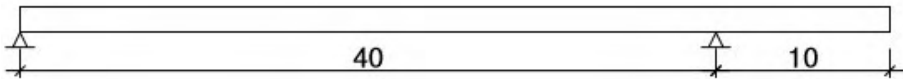

Figure 5 - Prestressed beam.

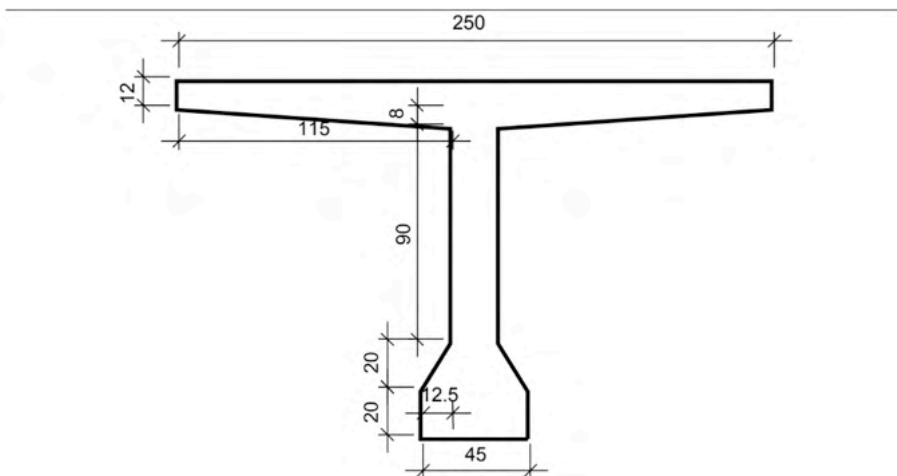

Figure 6 - Girder cross-section.

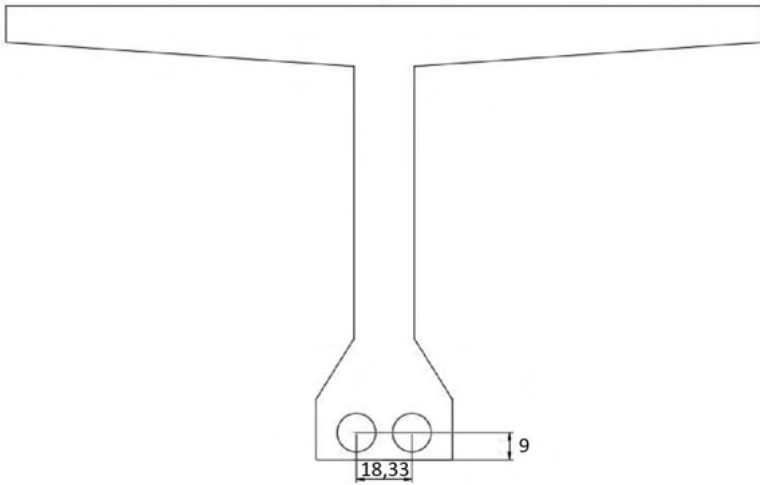

Figure 7. Automated optimum final detailing.

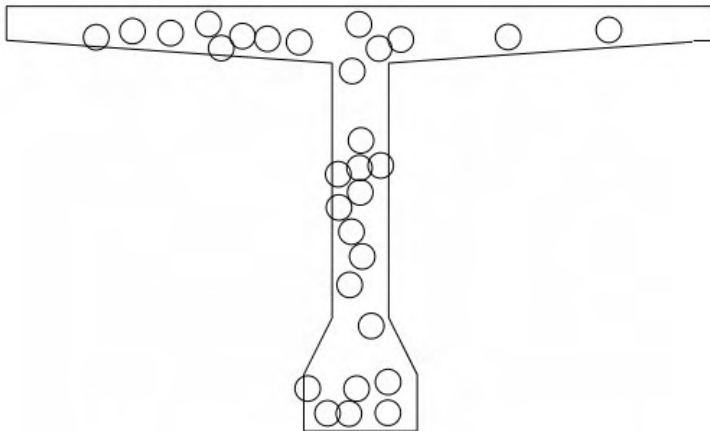

Figure 8. Result for naive objective function.

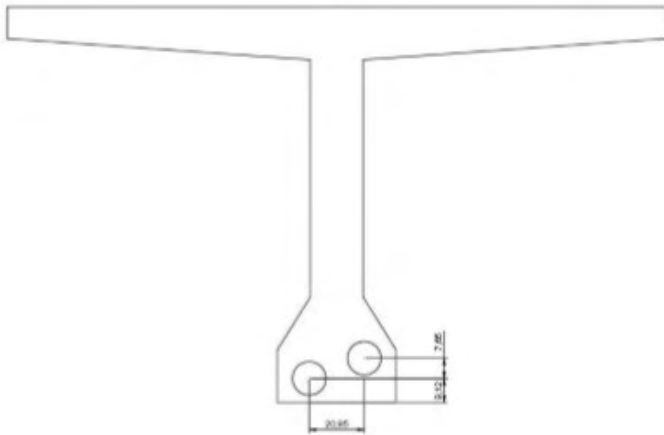

Figure 9. Result for objective function that does not favor symmetry.

5.2 Box Girder

Considering the cross-section shown in Fig. 10 with a required stress $\leq -30711.3\text{kPa}$. The obtained detailing is shown in Fig. 11. It should be noticed that, the concrete adopted here has compressive strength $f_{ck} = 45\text{MPa}$ and the beam geometry differs from Fig. 5, since the span is 60m and the cantilever part is 20m long.

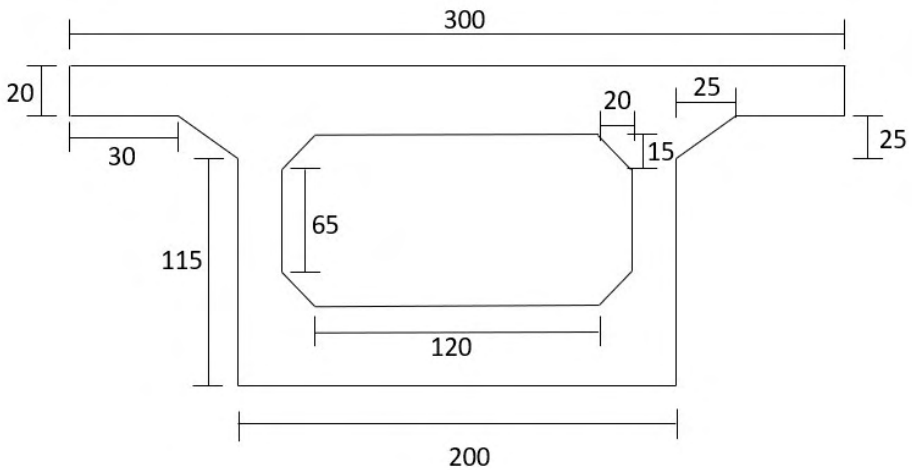

Figure 10. Box girder cross-section.

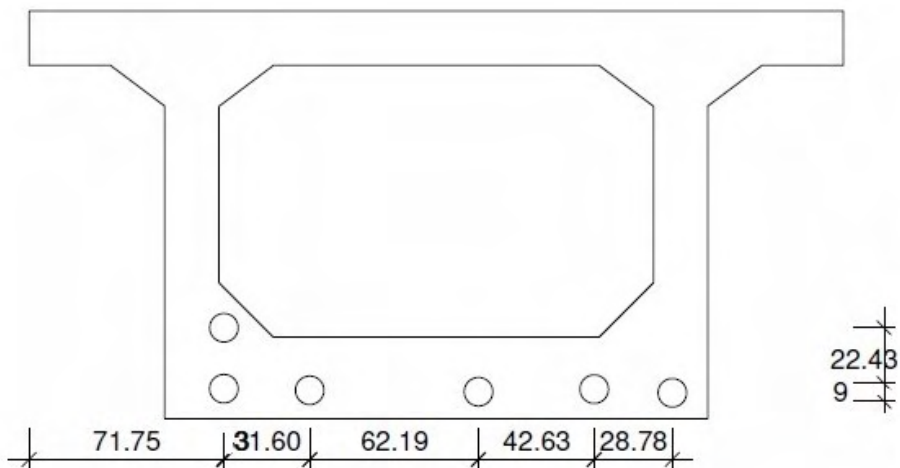

Figure 11. Box girder detailing.

6 | CONCLUSION

In this work a tool was developed to optimize the detailing of the active reinforcement in prestressed concrete beams with posterior adhesion and with complete or limited prestressing. The methodology for the development of this tool was to use the genetic algorithm, with the objective function imposing the minimum volume of steel.

The constructive method of prestressed concrete like any other method requires attention, but due to the fact that it requires an estimation of tension to begin the calculation of the project becomes even more complex. In this way the detailing of armor is fundamental. This step should be performed in the initial phases of a project and can prevent future errors in execution.

The optimum solution that delivers the cross section detailing of the beam was found after some changes in the objective function, as shown in the results. The incorporation of some practical rules did the difference in the search for better solutions, seeking to approximate the cables of the fiber more tensioned and make the same stay symmetrical with respect to y -axis. Thus, the solution found is close to the final solution. While the solution in Fig. 7 is very close to the final design, the solution in Fig. 11 is yet to be refined by designer. However, even when the algorithm does not provide a final design, it still furnishes a very good insight of what this design may look like.

The objective function does not imply a project with a more economical solution, however, by reducing the volume of steel, it is understood that this may occur for future projects since the cables are elements significant in the cost final of the project, this because they are high Resistance and high cost.

The tool is a breakthrough in relation to the initial phases of the current projects. The

manual process used in today's projects lasts at this stage an average of one day to find a satisfactory solution, based on the estimation of an experienced professional and still does not have the assurance that the solution found is the best possible. The tool developed in this project finds an optimized response in minutes, and can help new designers, innovate section models, reduce rework and execution time. For future projects The tool will be useful not to get a final project response, but it is of great value to apply it as an indicator of where it is most promising to detail the armor.

ACKNOWLEDGEMENTS

The authors would like to thank Ibmec for supporting this research project.

REFERENCES

- [1] Cholfe, L. & Bonilha, L., 2017. *Concreto Protendido*. PINI, São Paulo.
- [2] Hughes, J. F., Van Dam, A., Mcguire, M., Sklar, D. F., Foley, J. D., Feiner, S. K., & Akeley, K., 2013. *Computer Graphics Principles and Practice*. Pearson Education, Ohio, USA.
- [3] Carvalho, R. C., 2017. *Estruturas em Concreto Protendido*. PINI, São Paulo.
- [4] de Leon F. de Carvalho, A. P., 2009. *Algoritmos Genéticos*. São Carlos.
- [5] Protende, 2013. *Catálogo*.
- [6] NBR6118, 2014. *Projeto de estruturas de concreto - Procedimento*. Associação Brasileira de Normas Técnicas, Rio de Janeiro.
- [7] NBR8681, 2003. *Ações e segurança nas estruturas - Procedimento*. Associação Brasileira de Normas Técnicas, Rio de Janeiro.

ÍNDICE REMISSIVO

A

Acoplamento termomecânico 44, 48, 52

Algoritmo genético (AG) 244

Alvenaria estrutural 4, 44, 48

Análise de imagem 235, 240, 241

Aprendizado de máquina 2

Arduino 17, 18, 19, 20, 141, 142, 144, 145, 146, 147, 148, 152, 154, 157, 158, 159, 160, 161

Arquitetura de software 5, 74, 75, 76

B

Balanced spaces 34

Biblioteconomia clínica 21

Bluetooth 141, 142, 143, 144, 146, 147, 148, 151, 152, 154, 155, 156, 157, 158, 159, 160, 177

C

Cenários arquiteturais 5, 74, 87

Ciclo de vida arquitetural 74, 76, 77, 85, 87

Comunicação científica 3, 5, 57, 58

Conjuntos de similaridade 5, 105, 107, 108, 116

Correlação 235, 236, 240

D

Dados complexos 105, 106, 107, 108

Design science research 57, 58, 59, 62

Desigualdade de gênero na TI 173, 174

Dibujo asistido por computadora 6, 162, 163, 164, 171

E

Educación a distancia 162, 164, 165, 168, 170, 171

Elementos finitos 3, 48, 52, 53, 223

Energia renovável 185

Equivalência de funções 6, 118

F

Fibra de carbono 223

G

Gêmeo digital 5, 63, 64, 68, 71

Grafos 105, 112, 259, 261

H

Herramientas tecnológicas 6, 162, 163, 164, 170

Histórico feminino na TI 173, 174

Human comfort 198

I

Identificação de sistemas 185, 188, 189

Idosos 16, 17, 20

Indústria 4.0 63, 65, 66, 67

Infecções por Coronavirus 2

Interoperabilidade 21, 23, 24, 25, 26, 30, 32, 63, 64, 66, 67

J

JavaCV 235, 236, 237, 240, 241

JavaScript 141, 142, 153, 263

L

Ligas de alumínio 223

M

Memorandos técnicos 5, 74, 76, 78, 80, 81, 86, 87

Método sem malha local 243, 244

Método sem malha local com integração reduzida (ILMF) 244

Métrica de distância 5, 105, 113, 116

Microcontrolador 17, 141, 152

Mixed finite elements 34

Mulheres na TI 173, 174, 182, 183

Mulheres nos cursos superiores de TI 173, 174

O

Ontologias 21, 22, 23, 24, 25, 29, 30, 31, 32

opencv 241

OpenCV 235, 236, 237, 240, 241

Optimal detailing 89

P

Poisson's equation 34, 36

Prestressed concrete 89, 90, 91, 92, 96, 103

R

Rami 4.0 65

RAMI 4.0 63, 64, 65, 66, 67, 68, 69, 71

Realidade aumentada 3, 5, 57, 58, 60, 62

Remédios 3, 4, 16, 17, 20

Resistência ao fogo 44, 45, 49, 50, 56

Resistência mecânica 50, 55, 223

Robotista 63

S

Sistemas ciberfísicos (CPS) 63, 64, 71

Static condensation 4, 34, 35, 36

Steel-concrete 6, 198, 199, 200, 202, 204, 205, 206, 216, 218, 221

T

Terminologias clínicas 4, 21, 23, 24, 25, 30

Teste de hipótese 105

U

Usinas eólicas 185

V

Vibrations 6, 198, 199, 212, 219, 220, 222

Visões do modelo 4+1 5, 74, 87

Visualização de dados 57

W

Wi-Fi 141, 142, 147, 148, 152, 153, 157, 158

COLEÇÃO

DESAFIOS DAS ENGENHARIAS:



ENGENHARIA DE COMPUTAÇÃO 3

-  www.atenaeditora.com.br
-  contato@atenaeditora.com.br
-  [@atenaeditora](https://www.instagram.com/atenaeditora)
-  www.facebook.com/atenaeditora.com.br

COLEÇÃO

DESAFIOS DAS ENGENHARIAS:

ENGENHARIA DE COMPUTAÇÃO 3

-  www.atenaeditora.com.br
-  contato@atenaeditora.com.br
-  [@atenaeditora](https://www.instagram.com/atenaeditora)
-  www.facebook.com/atenaeditora.com.br